

INSTALLATION INSTRUCTIONS



CHROME POP-UP GAS CAPS FOR SCREW-IN APPLICATIONS Part Number 02-006

Revenge Cycle chrome pop-up gas caps are designed to be used on all fuel tanks where standard OEM screw-in gas caps are used. For tanks equipped with fuel gauges, a matching chrome cover designed to replace the OEM fuel gauge complements the look of the pop-up gas cap. This requires the removal of the OEM fuel gauge directly from the wiring harness with a simple procedure leaving no damage to the motorcycle's wiring.

1. Disconnect the motorcycle's battery.
2. Unscrew the right-side gas cap from the tank and replace with the pop-up screw in cap. To **release** the pop-up, press the center of the cap and twist $\frac{1}{4}$ -turn **counter-clockwise**. Thread into fuel tank and **lock** the pop-up in place by pressing the center of the cap and twisting $\frac{1}{4}$ -turn **clockwise**.
3. Grasp the fuel gauge and gently pull it from the fuel tank.
4. Disconnect the Yellow and Black wires from the fuel float and leave them in the tank with the float.
5. Trace the Orange, Yellow and Black wires from the fuel gauge along the wiring harness to locate the plastic connector plug. **NOTE: the routing of these Orange, Yellow and Black wires varies from model to model.** Depending on how the wires are routed on your motorcycle, various clamps and/or tabs will be in place to contain the wiring. When removing the wires from these clamps and/or tabs be careful to avoid damaging or breaking them. **NO CLIPPING** of wires is necessary for removal.

SEE PAGE 2 FOR FIGURES 1 - 4

6. As shown in Figure 1, use the supplied connector pin removal tool (T-pin), and slip the point of the pin into the back of the connector. This will release a lock tab on the wire connector.
7. The pin will push in and then stop as shown in Figure 2. When the pin is inserted into the back of the connector as far as it will go, the wire can be gently pulled out of the connector.
8. Gently pull the wire and T-pin out of the connector as shown in Figure 3. Repeat this procedure for all remaining wires and carefully work them out of the routing tube in the fuel tank and then free of the motorcycle.
9. Install the cover that replaces the OEM fuel gauge with the white painted stripe shown in Figure 4 facing 12-o'clock, or toward the front of the motorcycle. Any other orientation will not allow this cover to seat properly. Push the cover in place to complete the installation.
10. Re-connect the motorcycle's battery.

INSTALLATION INSTRUCTIONS



**CHROME POP-UP GAS CAPS
FOR SCREW-IN APPLICATIONS**
Part Number 02-006

INSTALLATION DIAGRAMS AND PHOTOS

Figure 1

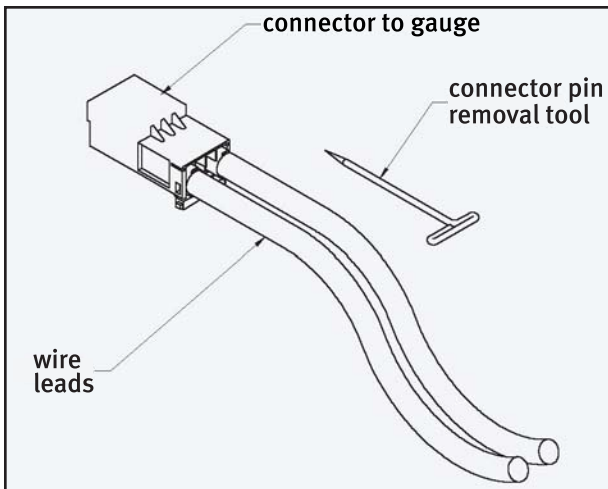

Figure 2

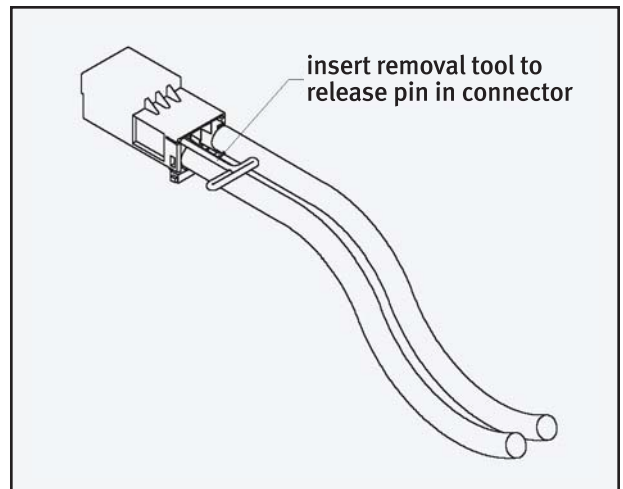

Figure 3

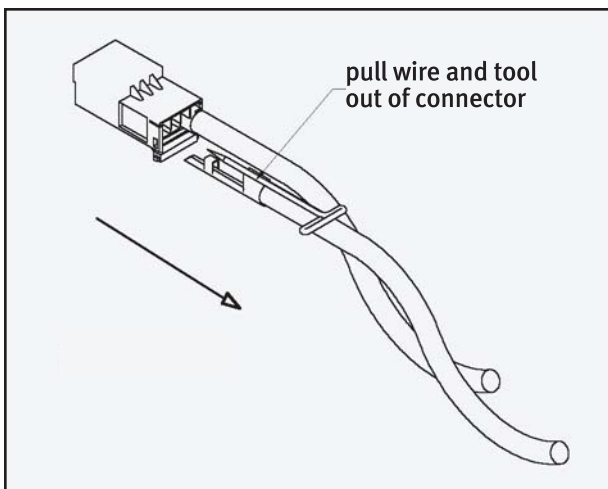
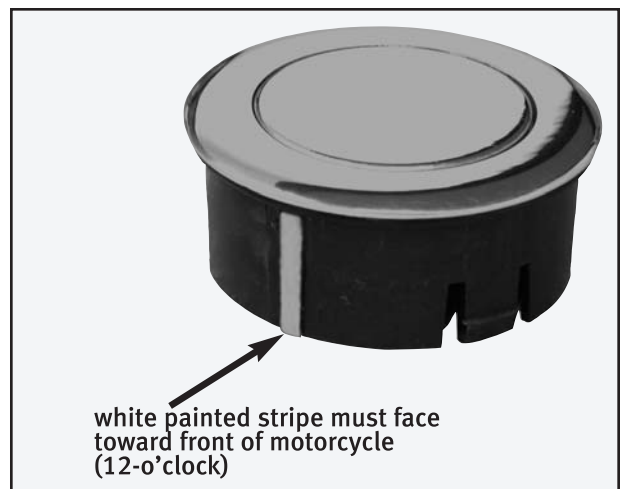

Figure 4



NOTE: Figures 1 -3 are for example of the wire removal procedure and show a 2-wire connector. Although the connector on the motorcycle is a 3-wire connector, the removal procedure is the same.